

CROWN MKIII

ASSEMBLY INSTRUCTIONS

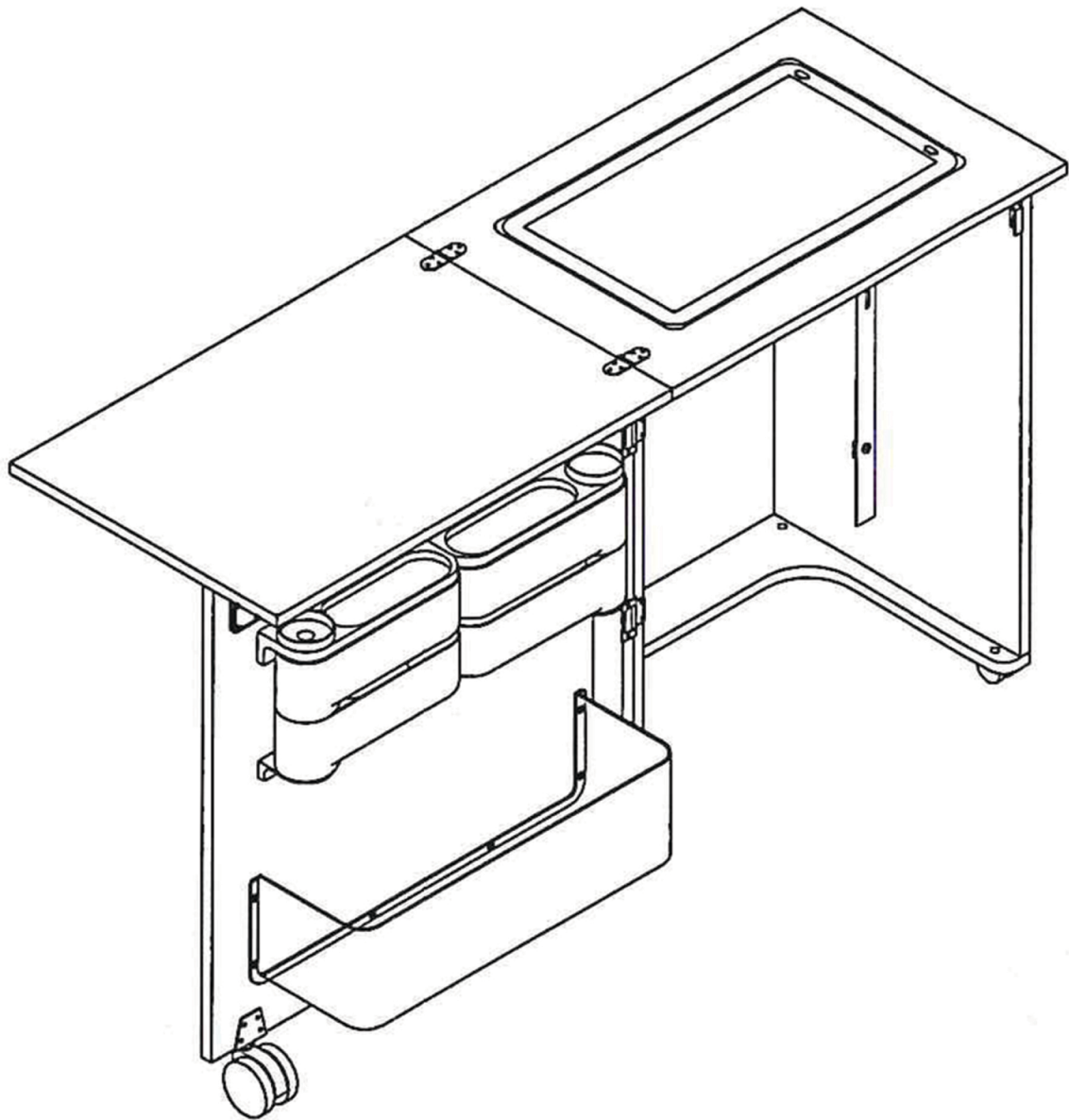

Scan the QR code below for follow-along video instructions on assembling your Crown MKIII. Ideally, use the manual alongside the video instructions.



A power drill / screwdriver is recommended for assembling this product, allowing for an easier and faster build.



⚡ ELECTRIC LIFT OPTION

If you have chosen for the electric lift upgrade. When installing the lift, you need to follow the electric lift guide. This will be extra documentation packed inside the lifter box.

Please refrain from testing the electric lift prior to completing assembly.

CROWN MKIII PANELS AND THEIR DESCRIPTIONS

Note: Hole positions helps with panel orientation.

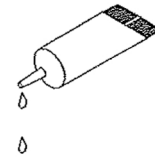
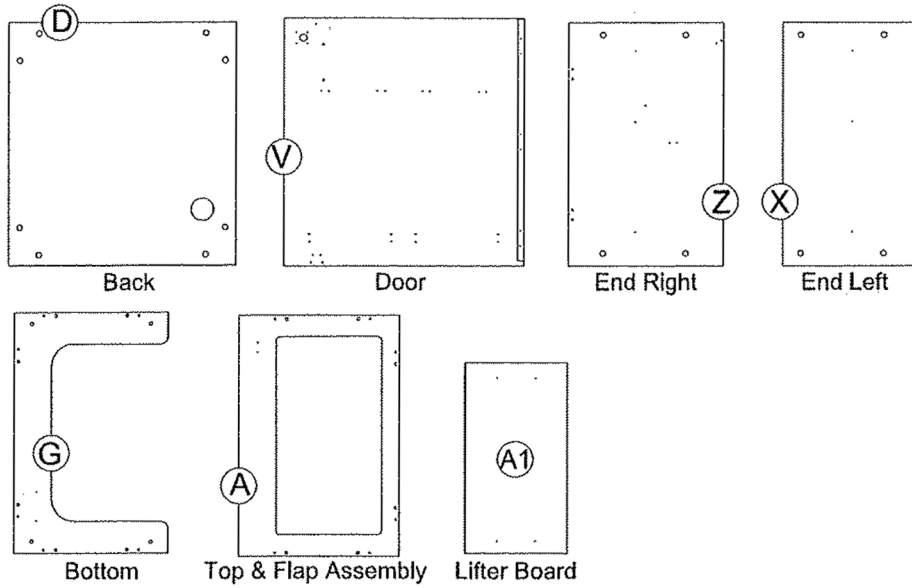

Before assembling place 2 to 3 drops of glue in dowel holes.
Do Not place glue in cam or cam bolt holes.

COMPONENTS				ACCESSORY BOX	DESCRIPTION	QTY
c3		Cam Ø15mm	19		Ramp	1
c1		Cam Bolt 30mm	19		Equalizer	1
d1		Dowel Ø8x30mm	18		Insert Holder	1
c2		Cam Cover	19		Pin Cushion Foam Ø65	2
s1		Screw Ø4x14mm C/S	17		Box Bracket	4
s2		Screw Ø3x14mm C/S	12		Door Bucket	2
s3		Screw Ø3.5x20mm C/S	6		Scissors Box and Circular Bracket	1
h1		Bow Handle	1		Toolbox	2
d2		Handle Screw	2		R/H Lifter Rail	1
		Glue Bottle	1		L/H Lifter Rail	1
t2		Castor Ø50mm	3		Large Lifter (612mm)	1
t1		Castor Ø50mm (Lock)	2			
g1		Castor Washer	4			
r3		Castor Spanner	1			
L2		Lock Striker	1			
h2		Flush Hinge 52mm	3			
L1		Lock & Key & Escutcheon	1			

1. Bottom Pre-Assembly

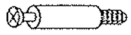

Cam Bolt Ø30mm (x6)



Insert Holder



Screw s1 Ø4x14mm (x2)

Assembly Steps

1. Screw Cam Bolts into the smaller holes as shown.
2. Locate the Insert Holder and secure using Screw s1 Ø4 x 14mm

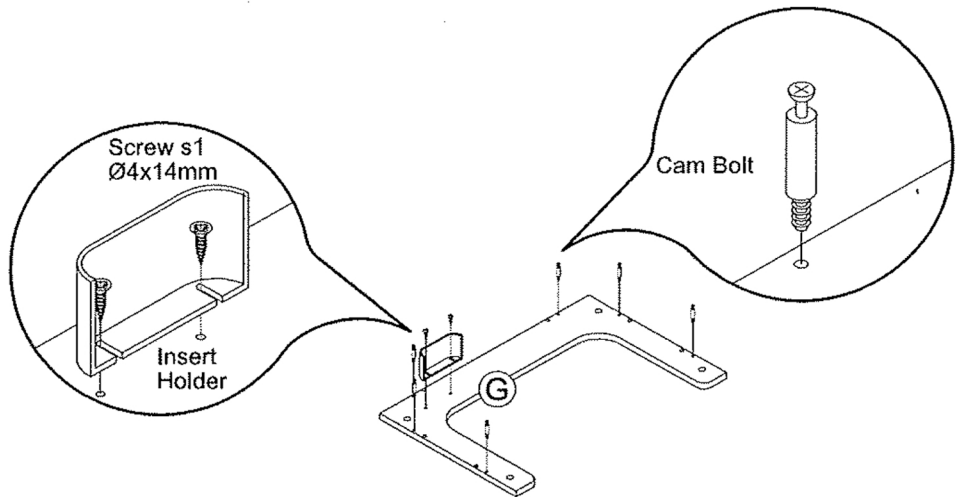

2. Top & Flap Pre-Assembly

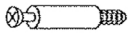

Cam Bolt Ø30mm (x6)



Ramp



Screw s3 Ø3.5x20mm (x2)

Assembly Steps

1. Screw Cam Bolts into the smaller holes as shown.
2. Locate and orientate the Ramp and secure using Screw s3 Ø3.5 x 20mm

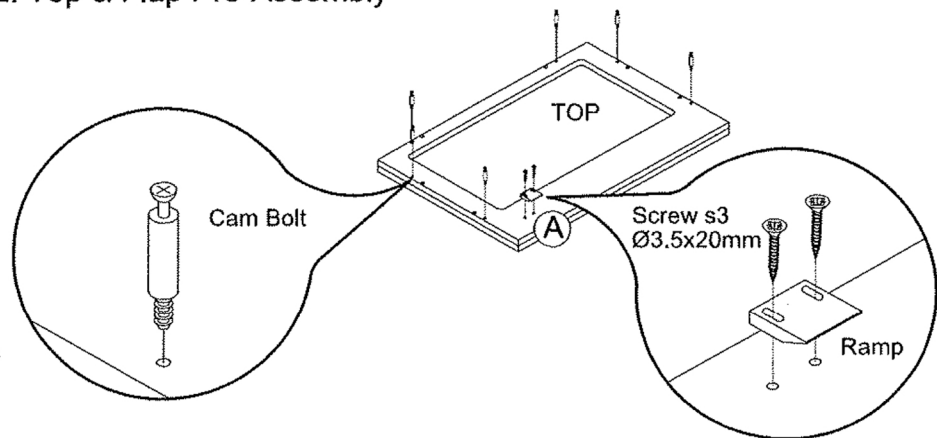

3. Left Hand End Pre-Assembly



Cam Ø15mm (x4)



Dowel Ø8x30mm (x4)



L/H Lifter Rail



Screw s1 Ø4x14mm (x3)



Cam Bolt Ø30mm (x2)

Assembly Steps

1. Press fit Cams into the End. Ensure the arrow on the Cam points to the nearest edge.
2. Place 2 to 3 drops of Glue in dowel holes in the End then tap Dowels into place.
3. Locate the L/H Rail so it is flush with the top of the panel and secure using Screw s1 Ø4 x 14mm
4. Screw Cam Bolts into the smaller holes as shown.

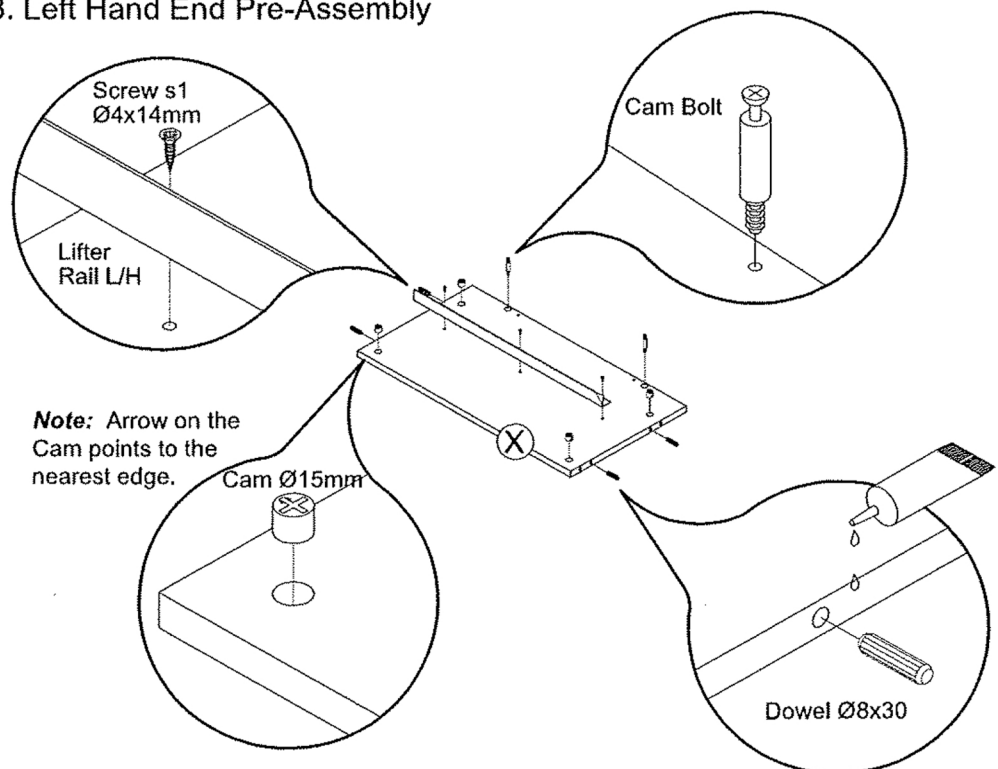

4. Right Hand End Pre-Assembly

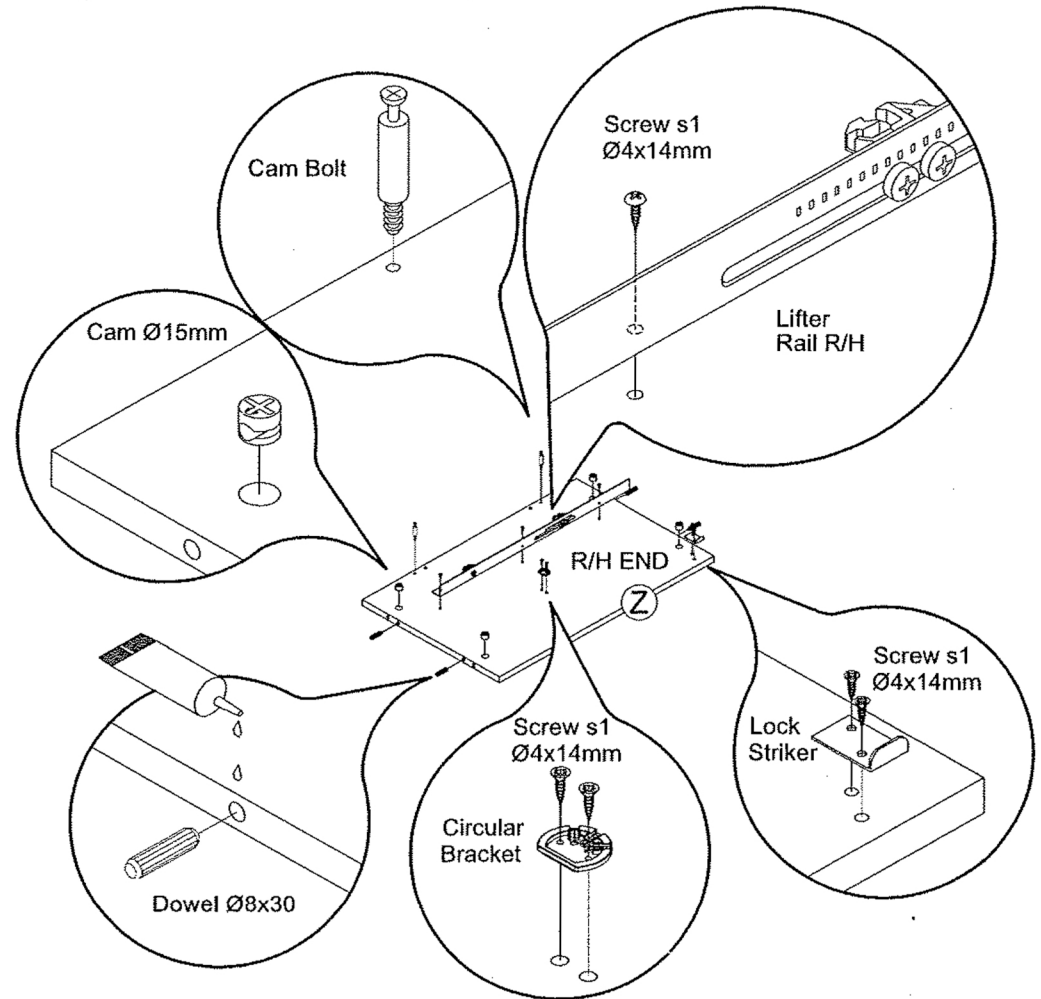
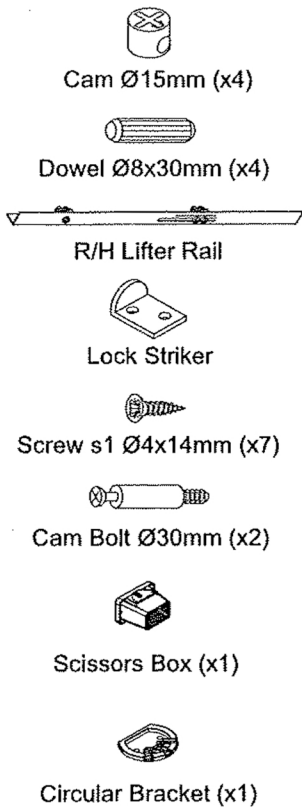

Assembly Steps

1. Press fit Cams into the End. Ensure the arrow on the Cam points to the nearest edge.
2. Place 2 to 3 drops of Glue in dowel holes in the End then tap Dowels into place.
3. Locate the R/H Rail so it is flush with the top of the panel and secure using Screw s1 Ø4 x 14mm
4. Locate Lock Striker and secure using Screw s1 Ø4 x 14mm
5. Screw Cam Bolts into the smaller holes as shown.
6. Locate Circular Bracket and secure using Screw s1 Ø4 x 14mm
7. Insert Scissors Box into Circular Bracket

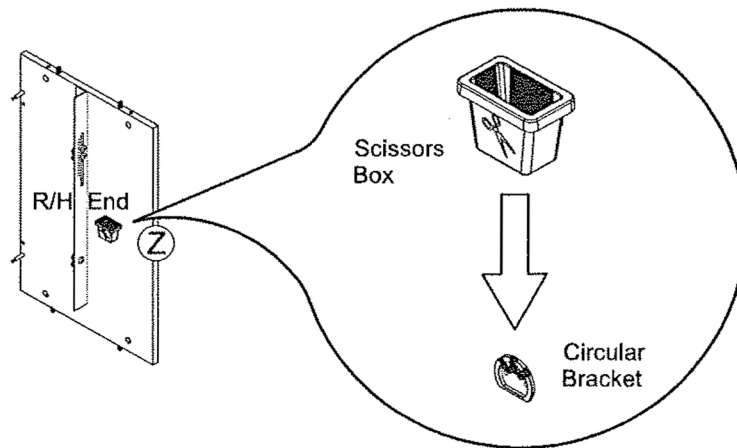

5. Back Pre-Assembly



Cam Ø15mm (x8)



Dowel Ø8x30mm (x8)

Assembly Steps

1. Press fit Cams into the Back. Ensure the arrow on the Cam points to the nearest edge.
2. Place 2 to 3 drops of Glue in dowel holes in the Back then tap Dowels into place.

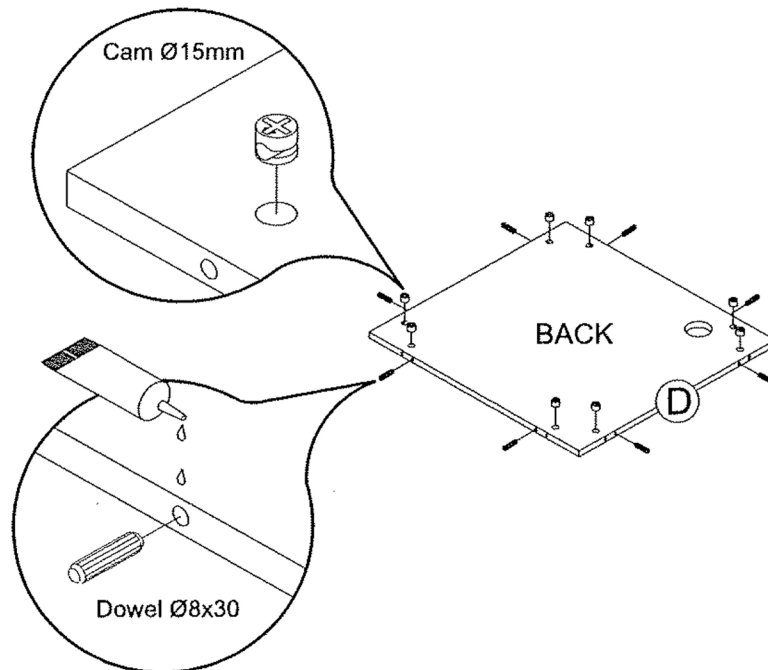

6. Door Pre-Assembly



Cam Ø15mm (x3)



Dowel Ø8x30mm (x2)

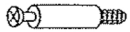

Cam Bolt Ø30mm (x3)

Assembly Steps

1. Press fit Cams into the Stud. Ensure the arrow on the Cam points to the nearest edge.
2. Place 2 to 3 drops of Glue in dowel holes in the Stud then tap Dowels into place.
3. Screw Cam Bolts into the smaller holes as shown.
4. Place 2 to 3 drops of Glue into the dowel holes in the Door. Locate the Cam holes in the Stud over the Cam Bolts in the Door and insert. Secure by turning the Cam a half turn clockwise.

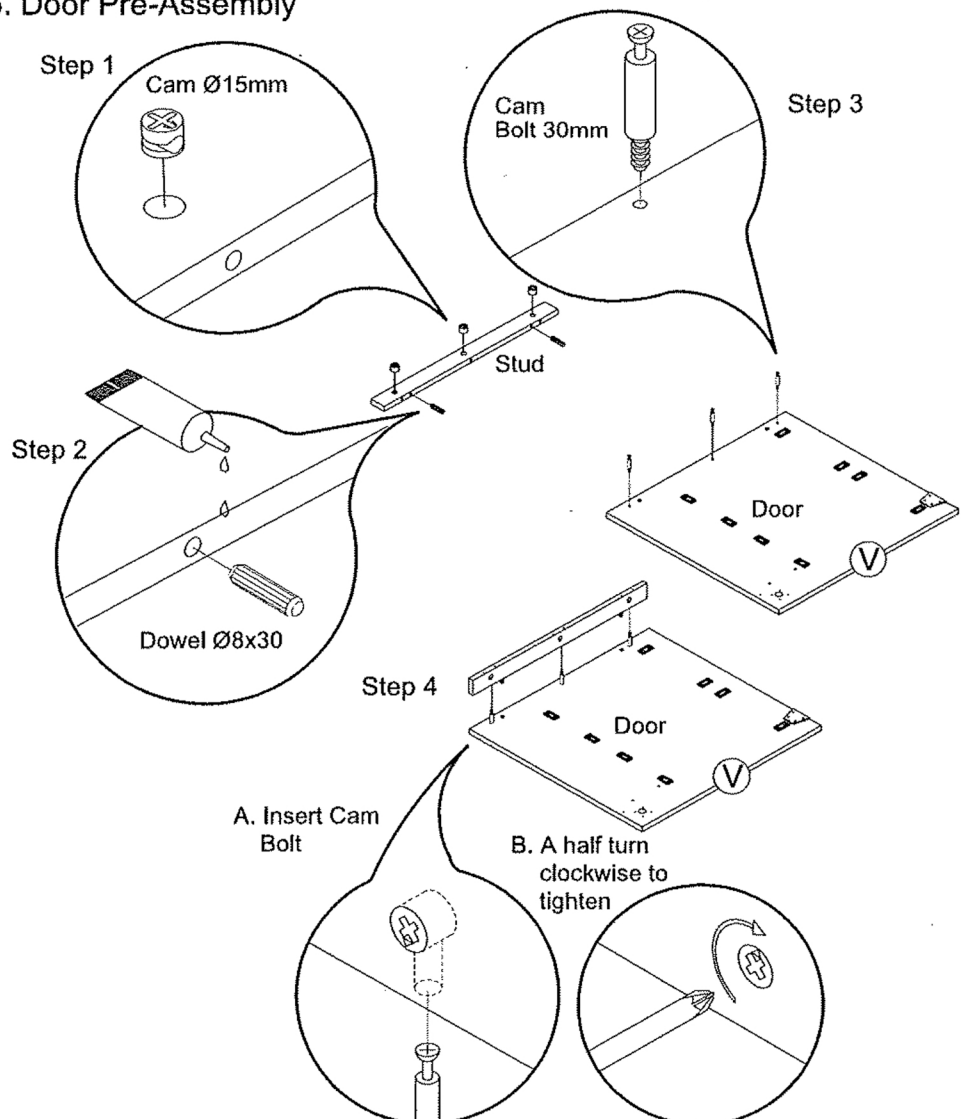

8. Bottom, Back, R/H End & L/H End Assembly

Assembly Steps

1. Place 2 to 3 drops of Glue into the dowel holes in the End. Locate the Cam holes in the End over the Cam Bolts in the Back and insert. Secure by turning the Cam a half turn clockwise.
2. Place 2 to 3 drops of Glue into the dowel holes in the Bottom. Locate the Cam holes in the End with Back over the Cam Bolts in the Bottom and insert. Secure by turning the Cam a half turn clockwise.

Step 1

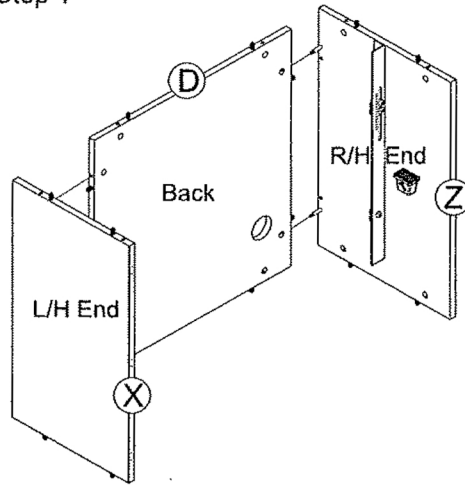

Step 2

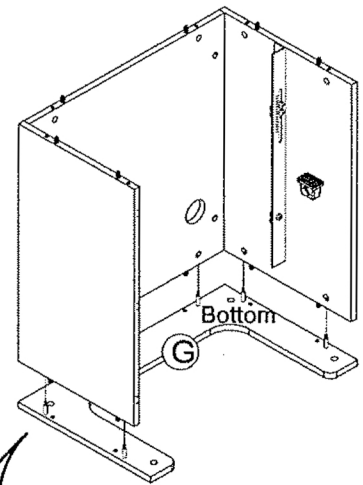

A. Insert Cam Bolt

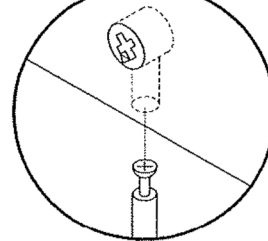

B. A half turn clockwise to tighten

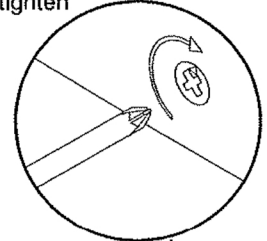

9. Lifter Board Pre-Assembly

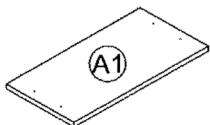

Lifter Board

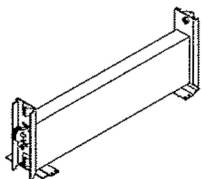

Lifter



Screw s1 Ø4x14mm (x4)

Assembly Steps

1. Locate the Lifter on the Lifter Board and secure using Screw s1 Ø4x14mm

Note: Check the Lifter is orientated correctly as shown.

Note: Lifter orientation on lifter board.

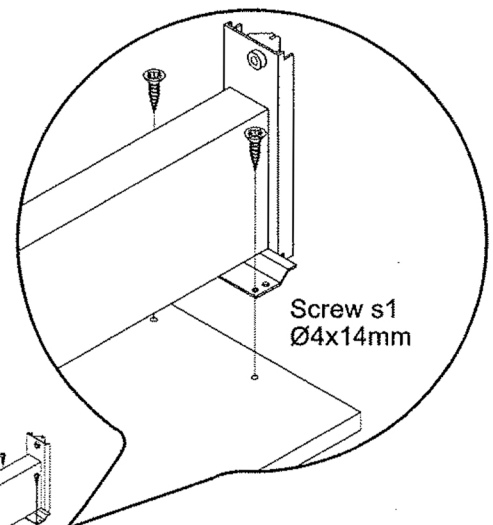
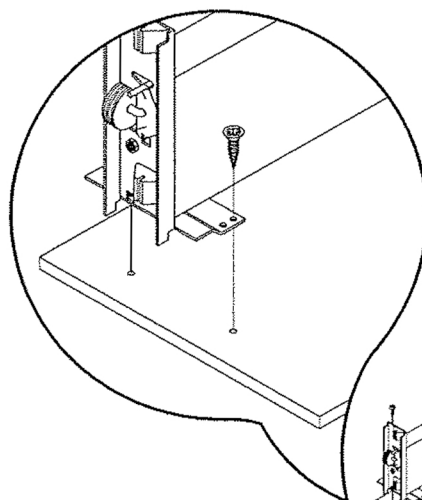

Screw s1
Ø4x14mm

10. Lifter Assembly

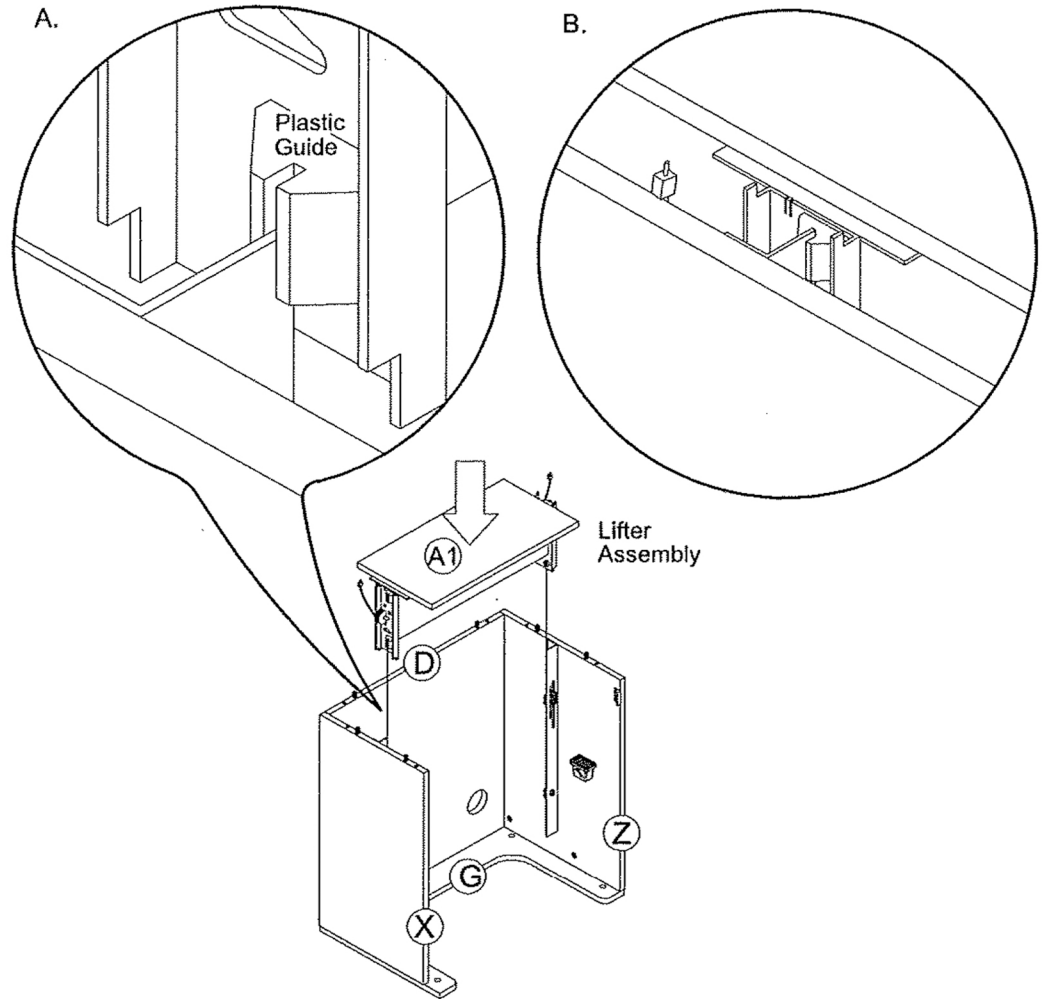

Assembly Steps

1. Position the Lifter Guides directly over the Rails and gently slide the Lifter into position.

Note:

Ensure all 4 plastic guides (2 on each side) are positioned correctly before going to the next step.

Note:

Lifter orientation when fitting

11. Lifter Cable Attachment

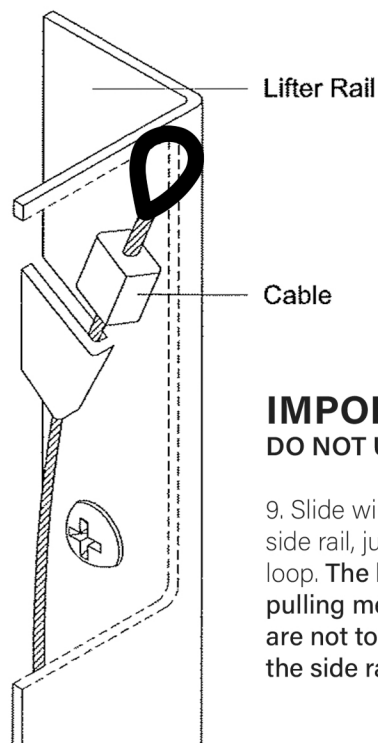

IMPORTANT DO NOT USE LOOP

9. Slide wire into hook on side rail, just underneath loop. The loops are simply a pulling mechanism, they are not to be hooked onto the side rails.

Assembly Steps

1. Loop Cable through Metal Tabs on the Lifter Rails. Ensure the cables are located on both the Left and Right Rails.
2. When fitted push down on the Lifter until it clicks into the first stop position. This may require a little force.

Note:

When the Lifter is clicked into the first stop position a small block of timber will disengage from the rear of the Lifter.

Discard the block.

12. Top Assembly

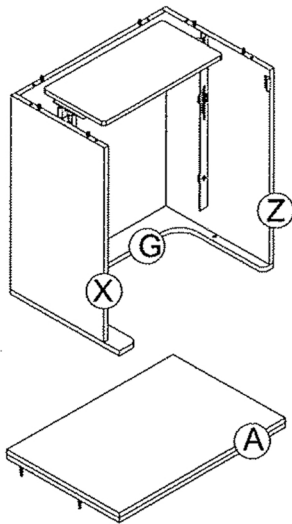

Top & Flap Assembly

Assembly Steps

1. Place 2 to 3 drops of Glue into the Dowel holes in the Top Assembly.
2. Locate the Cam Bolts in the Top and Flap Assembly over the Cams holes in the Left and Right hand Ends and insert. Secure by rotating the Cams a half turn clockwise.
3. Carefully roll the cabinet onto its back. This may require 2 people to perform safely.

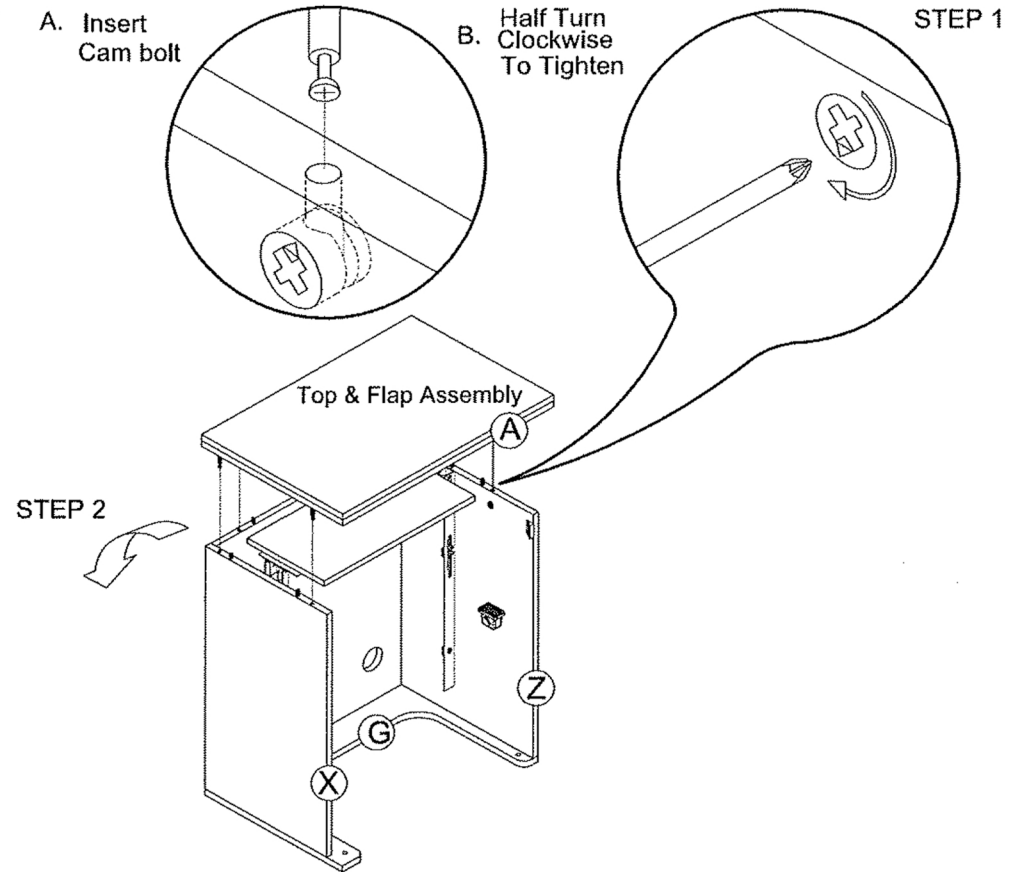

13. Castor Assembly



Castor Ø50mm (x2)



Castor Ø50mm (Lock) (x2)



Castor Washer (x4)



Insert Holder

Assembly Steps

1. Locate the Insert Holder and secure using Screw s1 Ø4 x 14mm
2. Place the Castor Washer over the Castor thread and screw into the bottom 'T' nuts. Secure using the Spanner provided.
3. Carefully lift the cabinet upright. **Note:** This may require 2 people to perform safely.

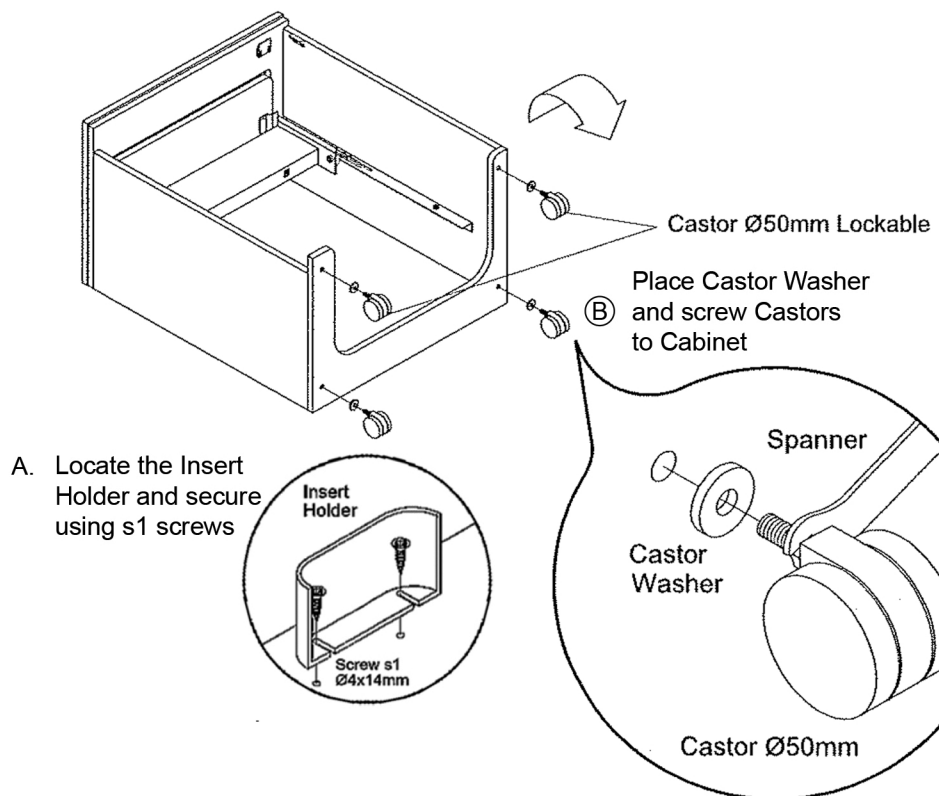

14. Door Assembly

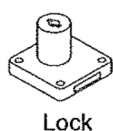

Screw s1 Ø4x14mm (x1)

Screw s2 Ø3x14mm (x6)

Screw s3 Ø3.5x20mm (x4)

Assembly Steps

1. Screw on Flush Hinge using Screw s2 Ø3x14mm C/S
2. Screw on Castor Ø50mm
3. Screw on Equalizer using Screw s1 Ø4x14mm C/S
4. Screw on Lock using Screw s3 Ø3.5x20mm C/S

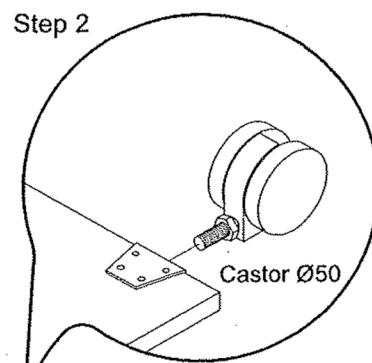
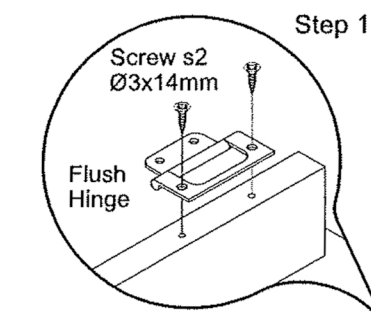

Note:
Tap Castor Bracket into the hole in the edge of the Door before inserting screws.

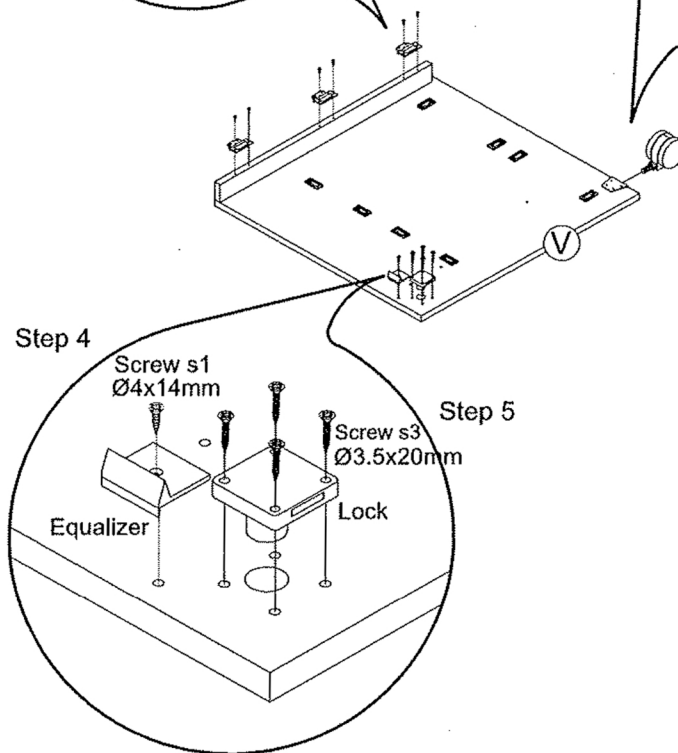

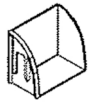

Box Bracket (x4)

Assembly Steps

1. Insert Box Bracket assembly into the Door Bracket

15. Box Bracket Assembly

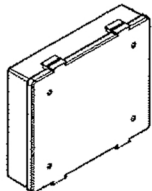
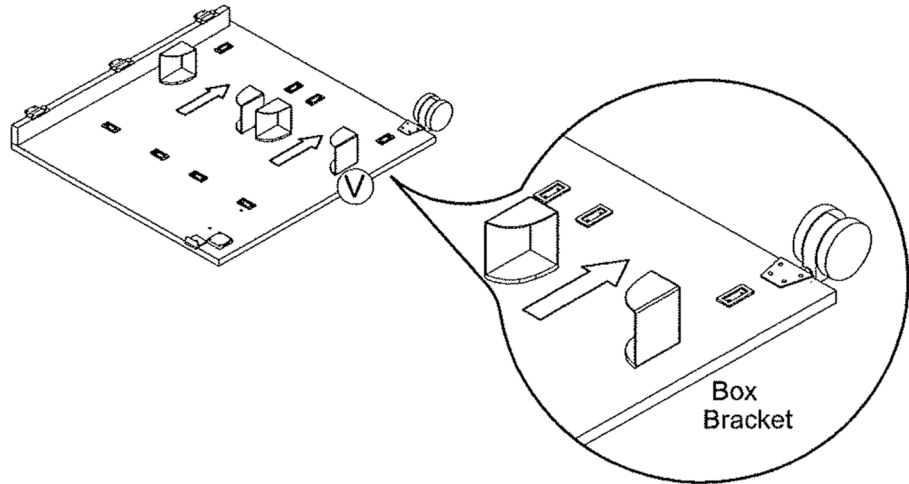

Toolbox (x2)

Assembly Steps

1. Put the Toolbox into the Box Bracket

16. Toolbox Assembly

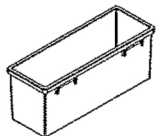
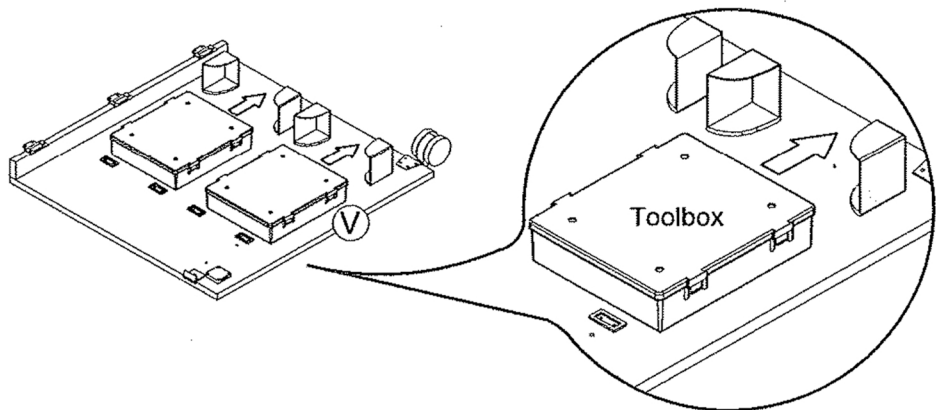

Door Bucket (x2)

Assembly Steps

1. Insert Door Bucket into the Square Bracket

17. Door Bucket Assembly

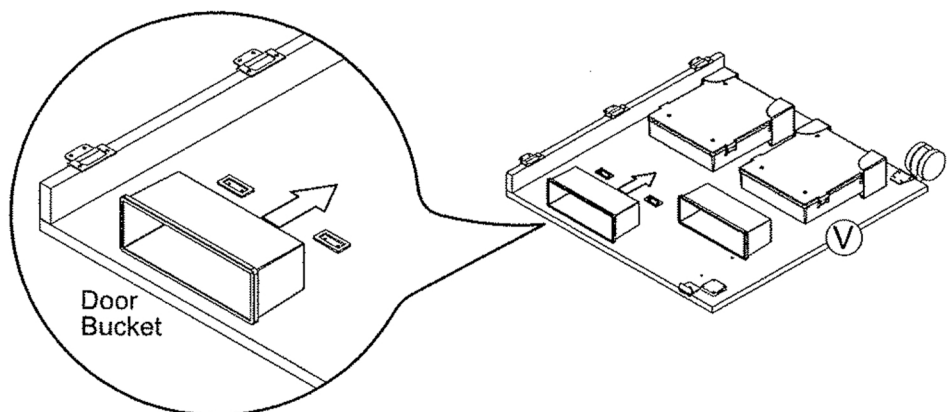

18. Fitting Door to Cabinet

Screw s2 Ø3x14mm (x6)



Escutcheon

Assembly Steps

1. Carefully position the Door and secure using Screw s2 Ø3x14mm
2. Press the Escutcheon into the Large Door.

Step 1.

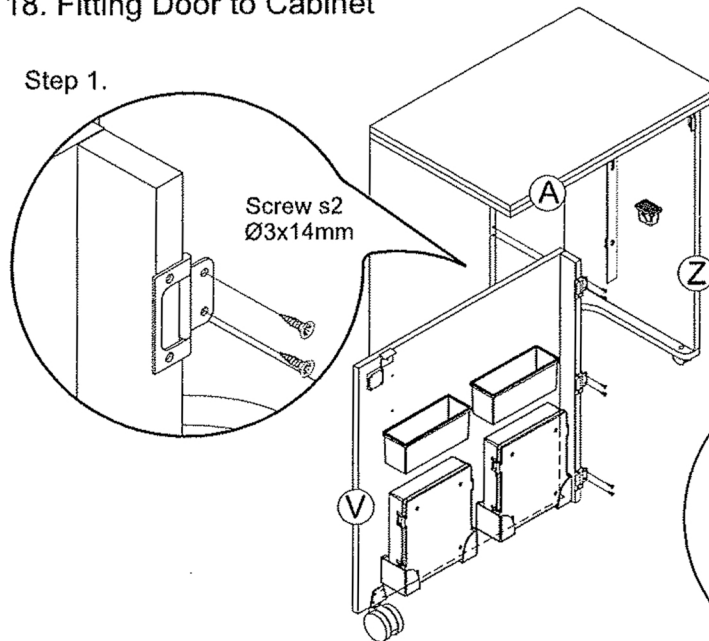

Step 2.

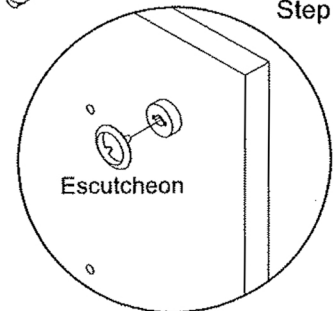

19. Fitting Door Handle



Bow Handle



Handle Screw (x2)

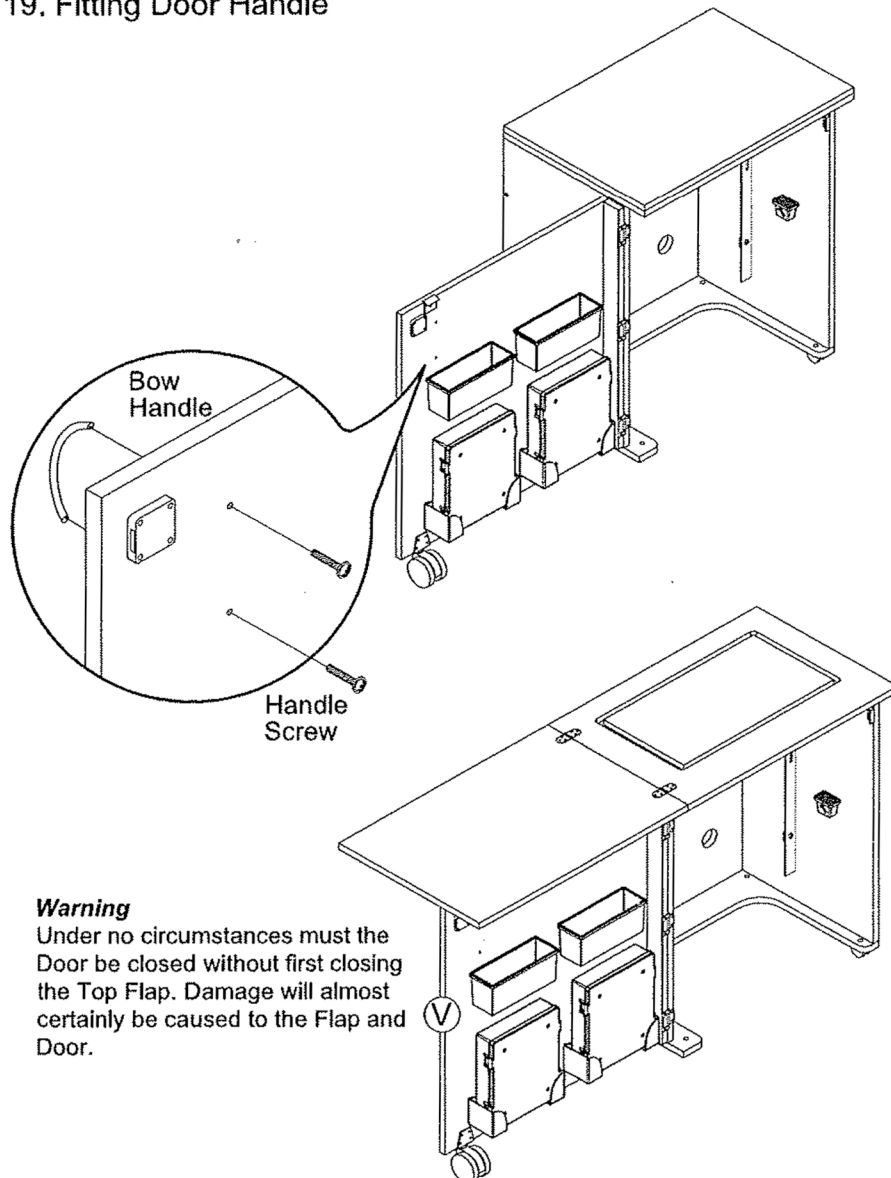

Assembly Steps

1. Fit the Bow Handle using Handle Screws

Warning

Under no circumstances must the Door be closed without first closing the Top Flap. Damage will almost certainly be caused to the Flap and Door.

