

Accessories not included

Crown MKIII

Congratulations on the purchase of your new Crown MKIII sewing cabinet. Every effort has been taken to ensure your complete satisfaction with this custom designed product. For your convenience the Crown MKIII is supplied in two ready to assemble packs.

Helpful Assembly Hints

Read the instructions carefully before starting. Check to see that all the parts are included. Work in a spacious area preferably on a carpet or soft surface. You will need a phillips head and flat head screw driver for the assembly. Cordless drill is preferable. Make sure you tighten all the screws securely and Tap dowels all the way in.

Warranty Information

Horn Australia Pty Ltd warrants this Crown MKIII sewing cabinet to be free from faulty parts or workmanship for a period of 12 months from the date of purchase. Under the terms of this warranty the repair and replacement of any parts shall be at the discretion of the company or their designated representatives. The warranty does not cover damaged caused by abuse, alteration, accident or neglect. The warranty does not cover damage caused as a result of moving the cabinet when loaded. Should service become necessary during the warranty period please contact your nearest Horn retailer. Product transportation is the owner's responsibility.

Crown MKIII Sewing Cabinet Care

Your Horn Crown MKIII normally requires a minimum amount of maintenance, however the following points are worth noting:

Cleaning - To remove marks and enhance the surface, wipe over with a general purpose cleaner.

Caution - Do not use ammonia based cleaning agents. Do not use harsh chemicals or abrasive cleaners. The surface can be wiped with a damp cloth but should be dried quickly.

CROWN MKIII PANELS AND THEIR DESCRIPTIONS

Note: Hole positions helps with panel orientation.

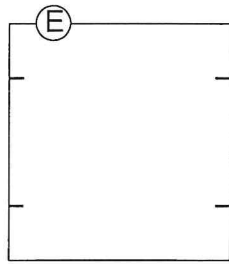

Back

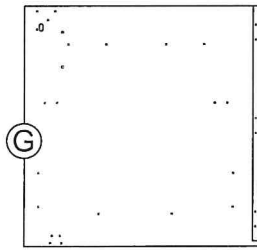

Door



End Right

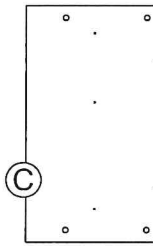

End Left

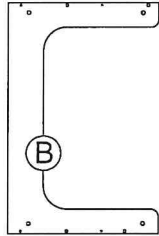

Bottom

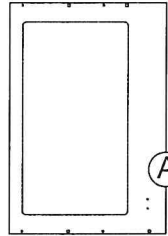

Top & Flap Assembly

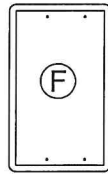

Lifter Board



Before assembling place 2 to 3 drops of glue in dowel holes.
Do Not place glue in cam or cam bolt holes.

COMPONENTS	DESCRIPTION	QTY
	Cam Ø15mm	8
	Cam Bolt 24mm	8
	Dowel Ø8x30mm	8
	Screw Ø5x57mm C/S	4
	Cover Cap For Screw Ø5x57mm	4
A	Screw Ø3.4x15mm C/S	37
D	Screw Ø3.5x18mm C/S	6
E	Screw Ø3 x 25mm C/S	8
	Bow Handle	1
	Handle Screw	2
	Glue Bottle	1
	Castor Ø50mm	3
	Castor Ø50mm (Lock)	2
	Castor Washer	4
	Castor Spanner	1
	Castor Bracket	1
	Flush Hinge 52mm	3

COMPONENTS	DESCRIPTION	QTY
	Basket Insert	1
	Ramp	1
	Lock Striker	1
	Equalizer	1
	Lock & Key	1
	Escutcheon	1
	Pin Cushion Foam Ø65	2
	Swivel Tray (Ass.)	2
	Door Tray (Left)	1
	Door Tray (Right)	1
	Swivel Tray Bracket	2
	Cotton Reel Insert	2
	Large Bucket	1
	R/H Lifter Rail	1
	L/H Lifter Rail	1
	Large Lifter (612mm)	1

	Insert Holder	1
--	---------------	---

1. Bottom Pre-Assembly



Cam Bolt Ø24mm (x4)

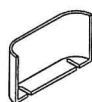

Insert Holder



Screw A Ø3.4x15mm (x2)

Assembly Steps

1. Screw Cam Bolts into the smaller holes as shown.
2. Locate the Insert Holder and secure using Screw A Ø3.4 x 15mm

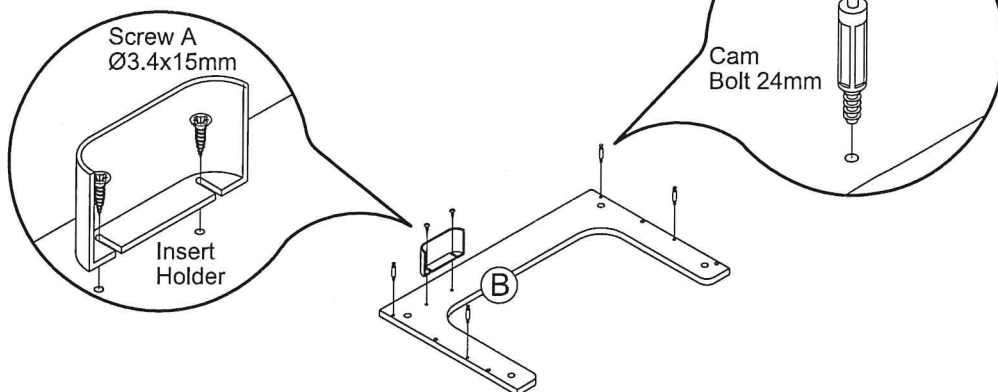

2. Top & Flap Pre-Assembly



Cam Bolt Ø24mm (x4)



Ramp



Screw D Ø3.5x18mm (x2)

Assembly Steps

1. Screw Cam Bolts into the smaller holes as shown.
2. Locate and orientate the Ramp and secure using Screw D Ø3.5 x 18mm

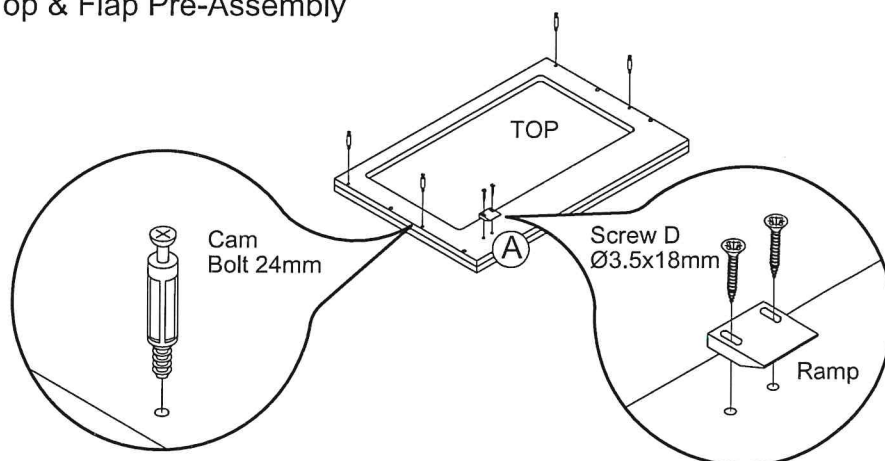

3. Left Hand End Pre-Assembly



Cam Ø15mm (x4)

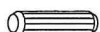

Dowel Ø8x30mm (x4)

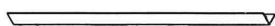

L/H Lifter Rail



Screw A Ø3.4x15mm (x3)

Assembly Steps

1. Press fit Cams into the End. Ensure the arrow on the Cam points to the nearest edge.
2. Place 2 to 3 drops of Glue in dowel holes in the End then tap Dowels into place.
3. Locate the L/H Rail so it is flush with the top of the panel and secure using Screw A Ø3.4 x 15mm

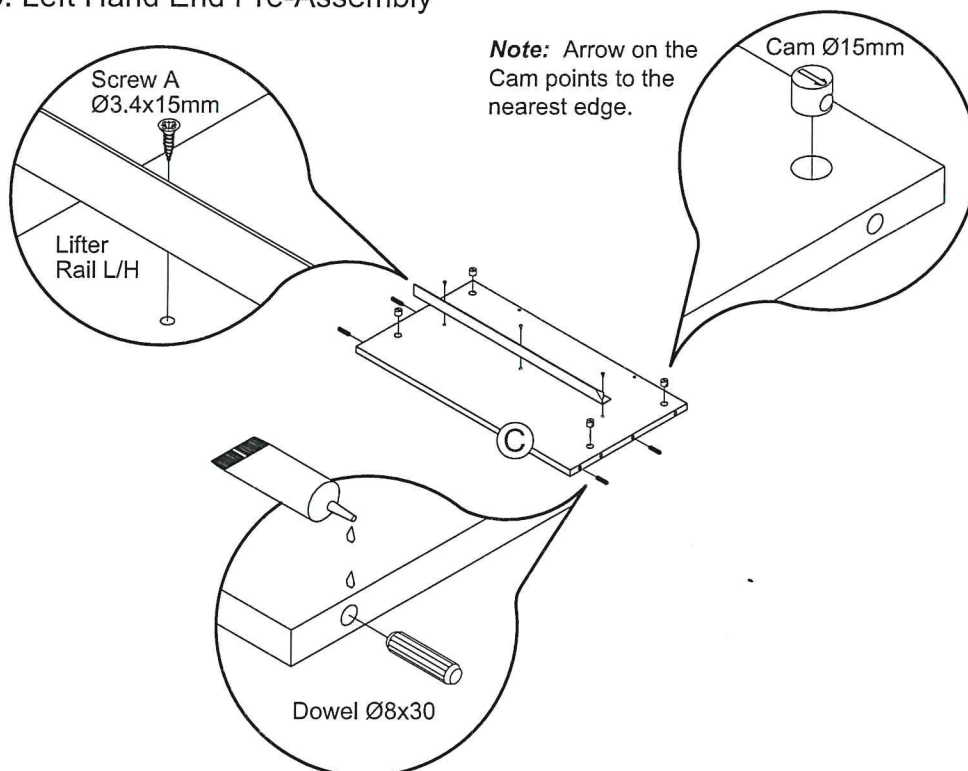

4. Right Hand End Pre-Assembly

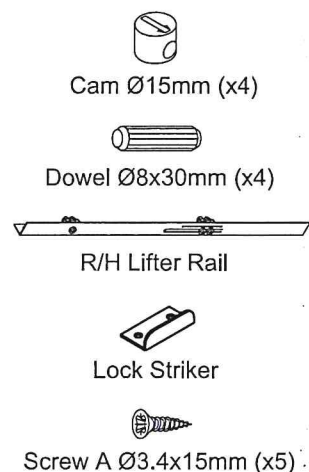

Assembly Steps

1. Press fit Cams into the End. Ensure the arrow on the Cam points to the nearest edge.
2. Place 2 to 3 drops of Glue in dowel holes in the End then tap Dowels into place.
3. Locate the R/H Rail so it is flush with the top of the panel and secure using Screw A Ø3.4 x 15mm
4. Locate Lock Striker and secure using Screw A Ø3.4 x 15mm

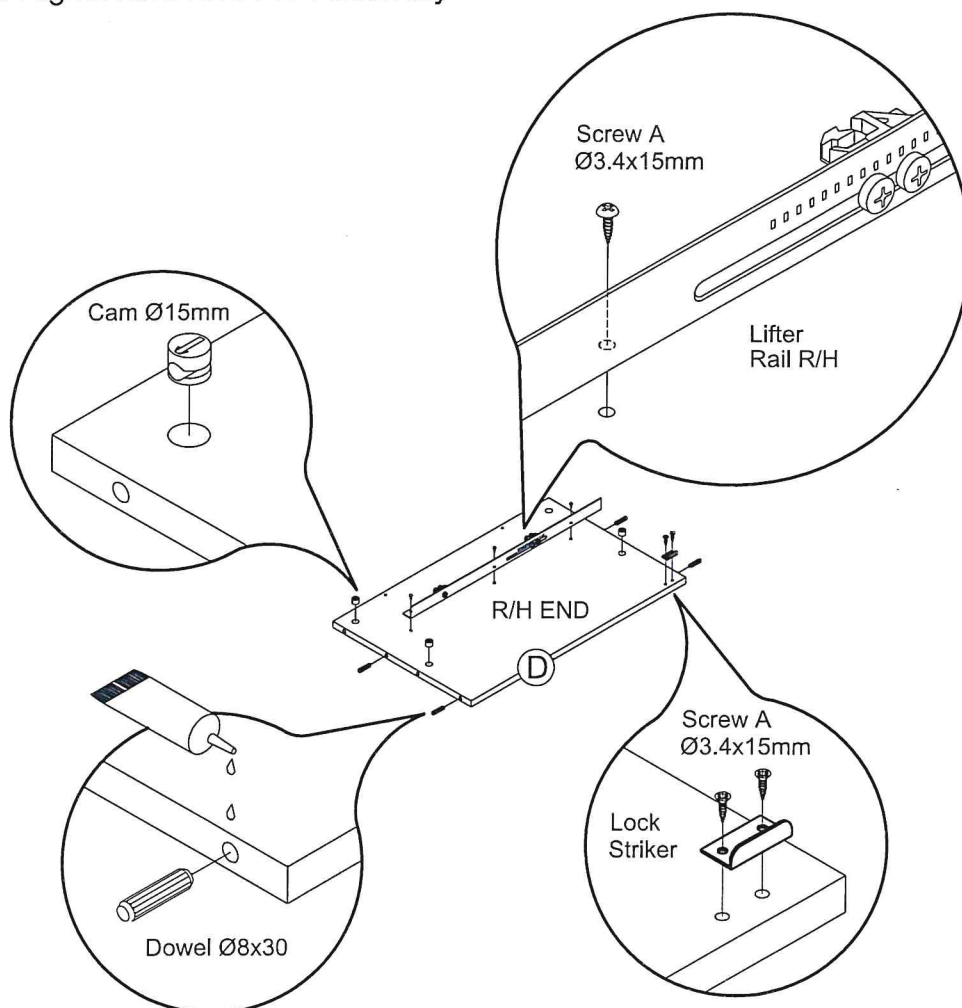

5. Bottom, Back & R/H End Assembly



Assembly Steps

1. Place 2 to 3 drops of Glue into the dowel holes in the Bottom. Locate the Cam holes in the End over the Cam Bolts in the Bottom and insert. Secure by turning the Cam a half turn clockwise.
2. Position the Back and secure to End using Screw Ø5x57mm
3. Press Cover Caps into the head of the screws

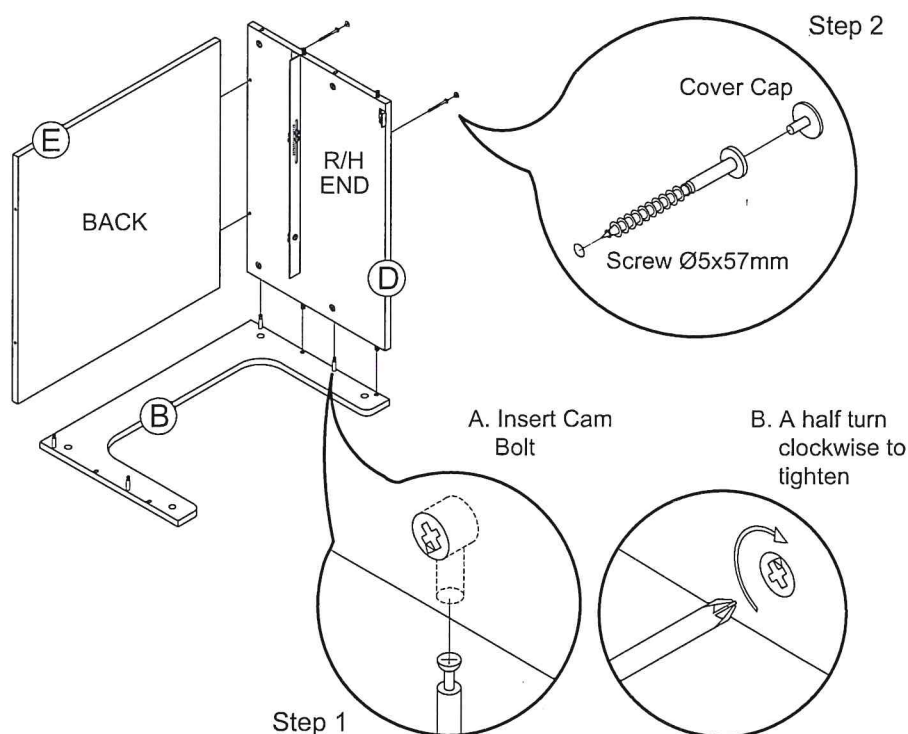

6. Bottom, Back & L/H End Assembly

 Screw Ø5x57mm (x2)

 Cover Cap (x2)

Assembly Steps

1. Place 2 to 3 drops of Glue into the dowel holes in the Bottom. Locate the Cam holes in the End over the Cam Bolts in the Bottom and insert. Secure by turning the Cam a half turn clockwise.
2. Position the Back and secure to End using Screw Ø5x57mm
3. Press Cover Caps into the head of the screws

Step 2

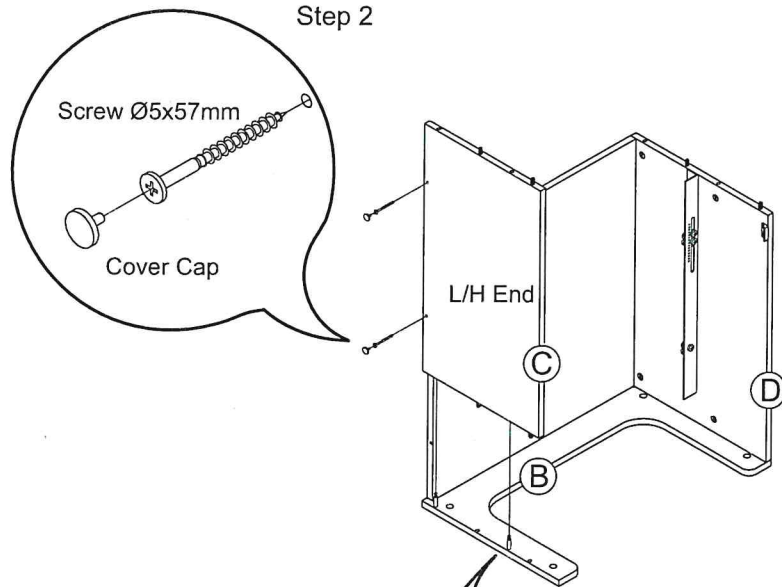

A. Insert Cam Bolt

B. A half turn clockwise to tighten

Step 1

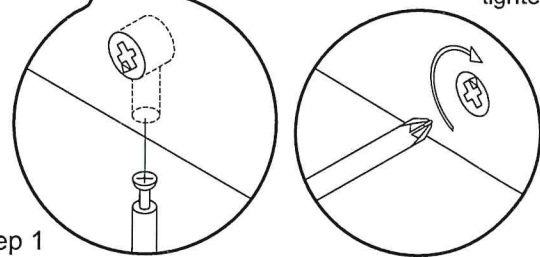

7. Lifter Board Pre-Assembly

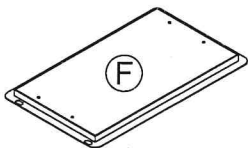

Lifter Board

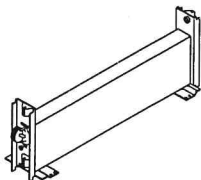

Lifter

 Screw A Ø3.4x15mm (x4)

Assembly Steps

1. Locate the Lifter on the Lifter Board and secure using Screw A Ø3.4x15mm

Note: Check the Lifter is orientated correctly as shown.

Note: Lifter orientation on lifter board.

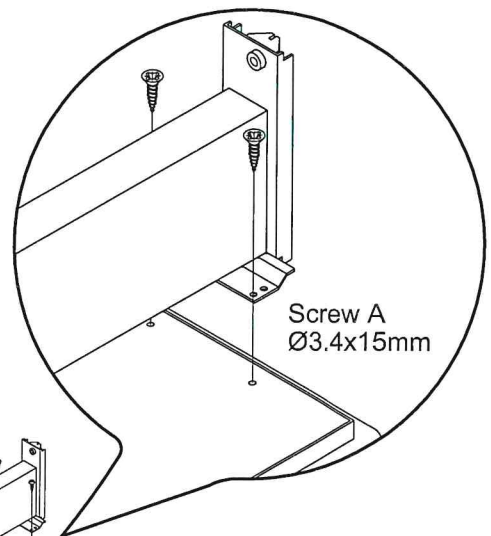
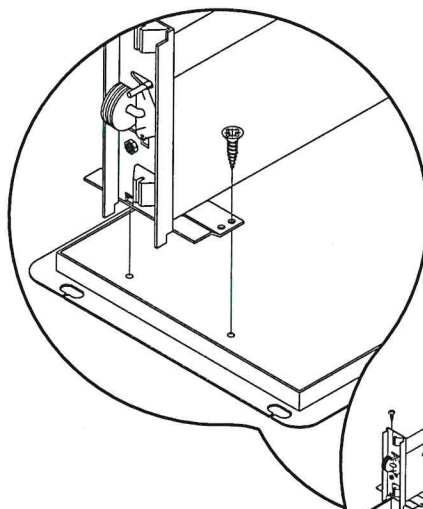

8. Lifter Assembly

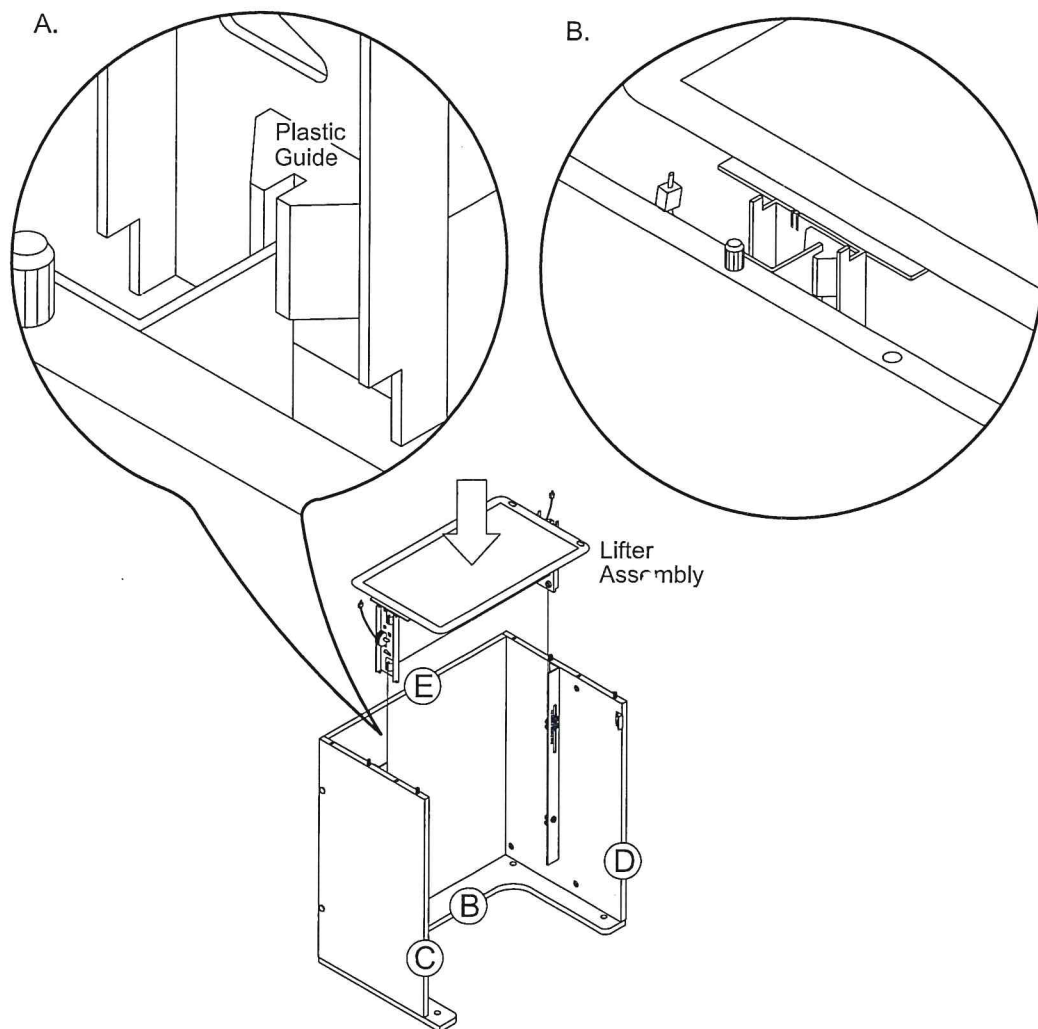

Assembly Steps

1. Position the Lifter Guides directly over the Rails and gently slide the Lifter into position.

Note:

Ensure all 4 plastic guides (2 on each side) are positioned correctly before going to the next step.

Note:

Lifter orientation when fitting

9. Lifter Cable Attachment

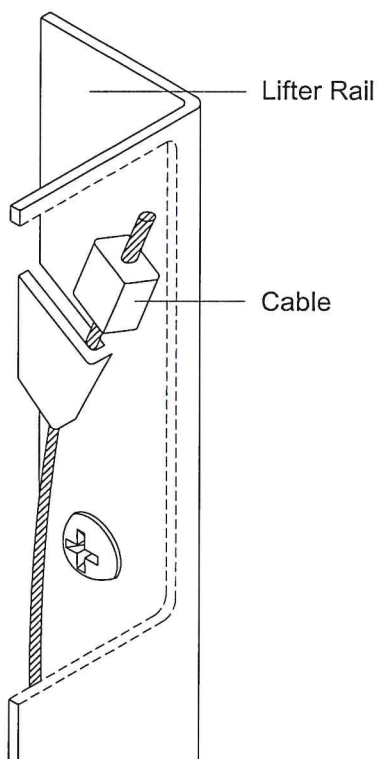

Assembly Steps

1. Loop Cable through Metal Tabs on the Lifter Rails. Ensure the cables are located on both the Left and Right Rails.
2. When fitted push down on the Lifter until it clicks into the first stop position. This may require a little force.

Note:

When the Lifter is clicked into the first stop position a small block of timber will disengage from the rear of the Lifter.

Discard the block.

10. Top Assembly

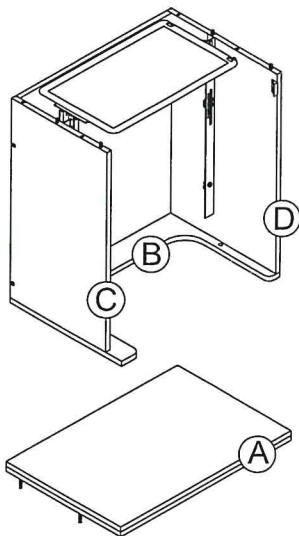

Top & Flap Assembly

Assembly Steps

1. Place 2 to 3 drops of Glue into the Dowel holes in the Top Assembly.
2. Locate the Cam Bolts in the Top and Flap Assembly over the Cams holes in the Left and Right hand Ends and insert. Secure by rotating the Cams a half turn clockwise.
3. Carefully roll the cabinet onto its back. This may require 2 people to perform safely.

10. Top Assembly

A. Insert Cam bolt

B. Half Turn Clockwise To Tighten

STEP 1

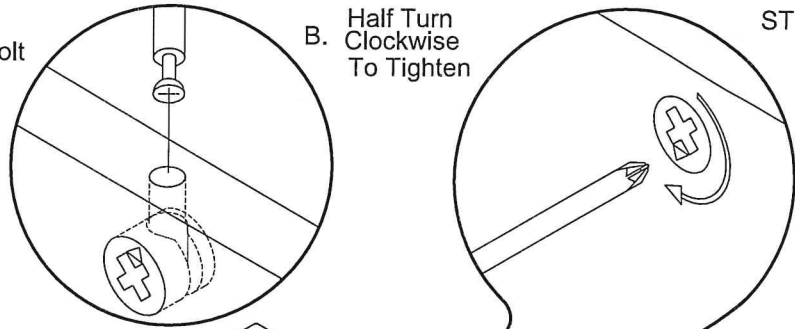

STEP 2

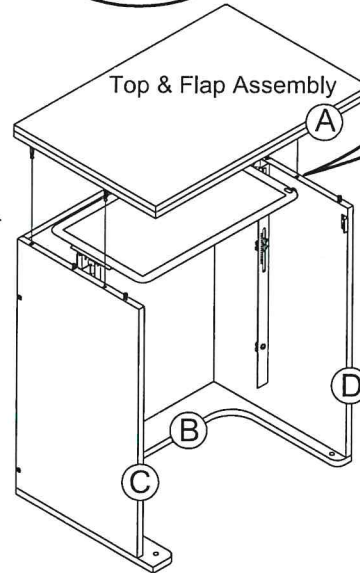
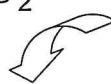

11. Castor Assembly

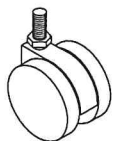

Castor Ø50mm (x2)

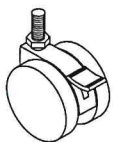

Castor Ø50mm (Lock) (x2)



Castor Washer (x4)

Assembly Steps

1. Place the Castor Washer over the Castor thread and screw into the bottom 'T' nuts. Secure using the Spanner provided.
2. Carefully lift the cabinet upright. **Note:** This may require 2 people to perform safely.

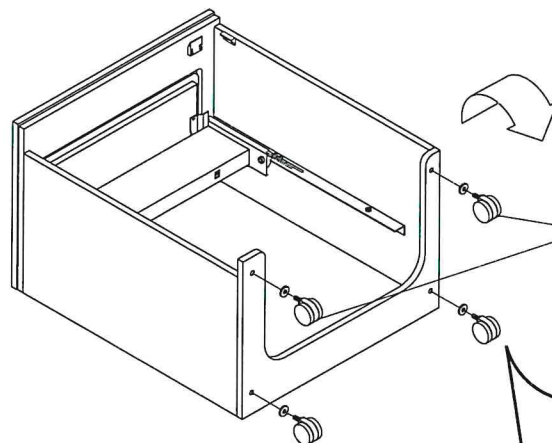

Castor Ø50mm Lockable

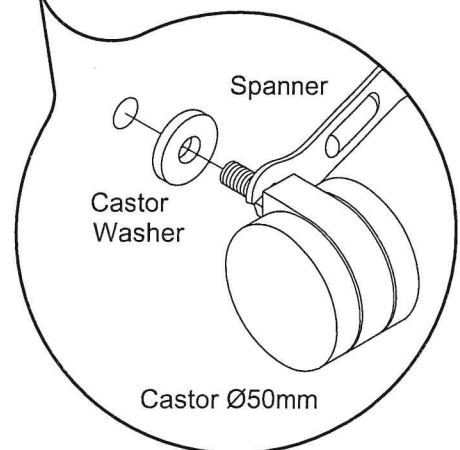

Spanner

Castor Washer

Castor Ø50mm

12. Door Assembly



Castor Ø50mm (x1)



Flush Hinge (x3)



Castor Bracket

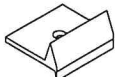

Equalizer

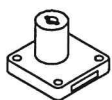

Lock

Screw A Ø3.4x15mm (x11)

Screw D Ø3.5x 18mm (x4)

Assembly Steps

1. Screw on Flush Hinge using Screw A Ø3.4x15mm C/S
2. Screw on Castor Bracket using Screw A Ø3.4x15mm C/S
3. Screw on Castor Ø50mm
4. Screw on Equalizer using Screw A Ø3.4x15mm C/S
5. Screw on Lock using Screw D Ø3.5x18mm C/S

Step 1

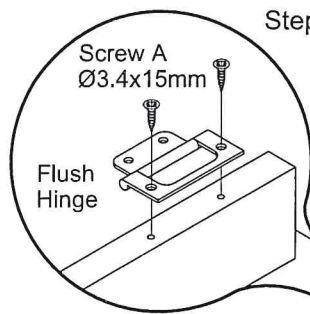

Step 2

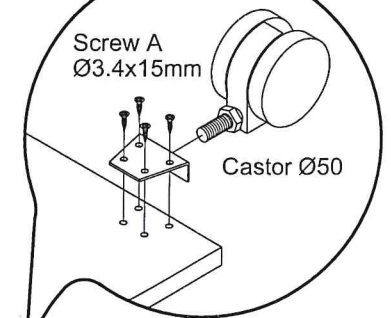

Note:
Tap Castor Bracket into the hole in the edge of the Door before inserting screws.

Step 4

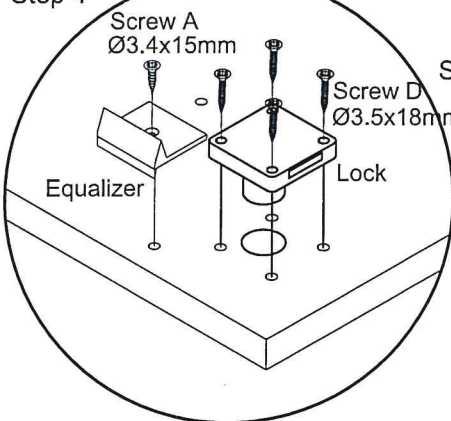

Step 5

Screw D Ø3.5x18mm

13. Door Tray Assembly



Door Tray (Left)

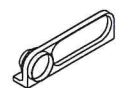

Door Tray (Right)



Screw E Ø3.0 x 25mm (x4)

Assembly Steps

1. Screw on Left Hand & Right Hand Door Shelf using Screw Ø3.0 x 25mm.

Step 1

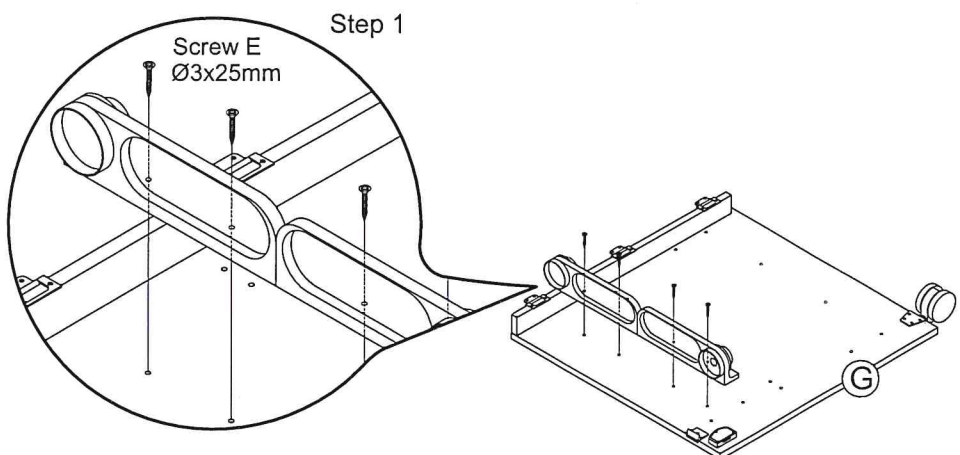

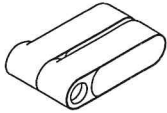

Swivel Tray Assembly (x2)

Assembly Steps

1. Insert Swivel Tray assembly into the Left Hand and Right Hand Door Shelves

14. Swivel Tray Assembly

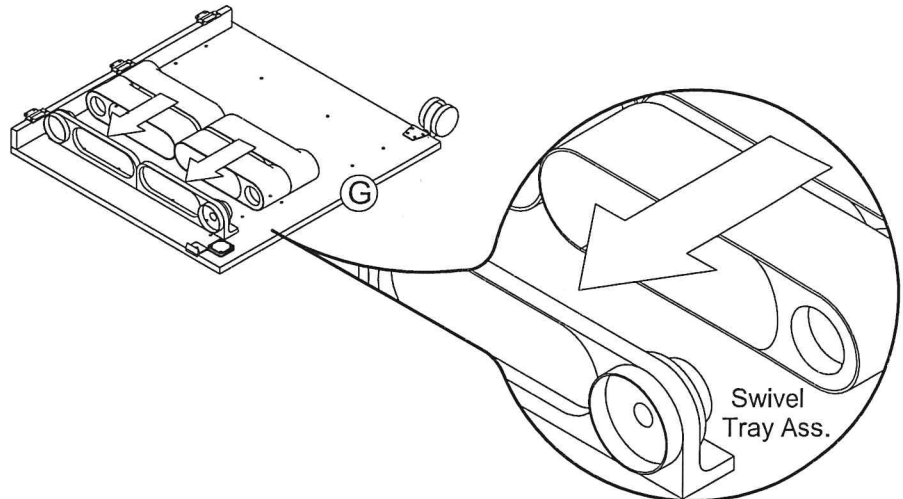

Swivel Bracket (x2)



Screw E Ø3x25mm (x4)

Assembly Steps

1. Press fit the Swivel Bracket into the base of Swivel Tray assemblies and secure to the Door using Screw E Ø3.0 x 25mm

15. Swivel Tray Assembly

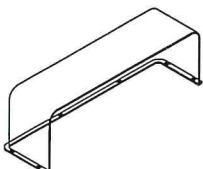
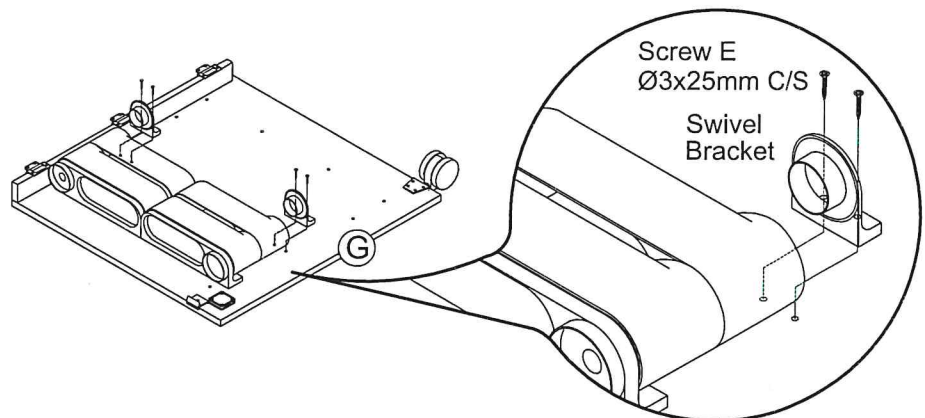

Large Bucket



Screw A Ø3.4x15mm (x6)

Assembly Steps

1. Position the Large Bucket and secure using Screw A Ø3.4x15mm C/S

16. Large Bucket Assembly

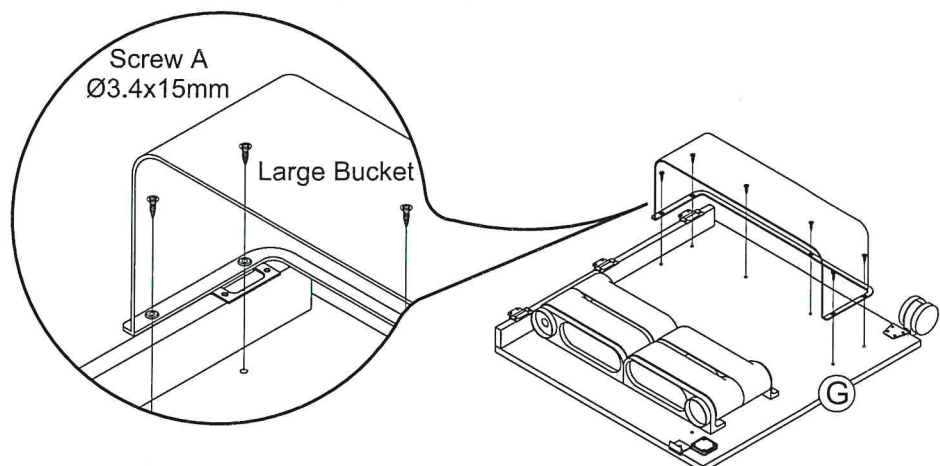

17. Fitting Door to Cabinet

 Screw A Ø3.4x15mm (x6)

 Escutcheon

Assembly Steps

1. Carefully position the Door and secure using Screw A Ø3.4x15mm
2. Press the Escutcheon into the Large Door.

Step 1.

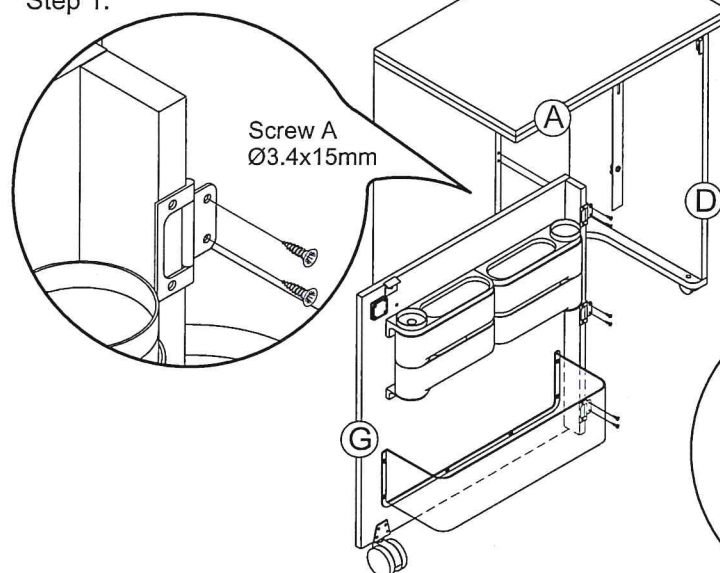

Step 2.

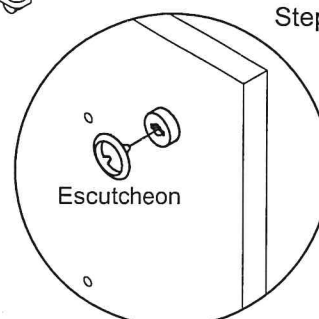

18. Fitting Door Handle

 Bow Handle

 Handle Screw (x2)

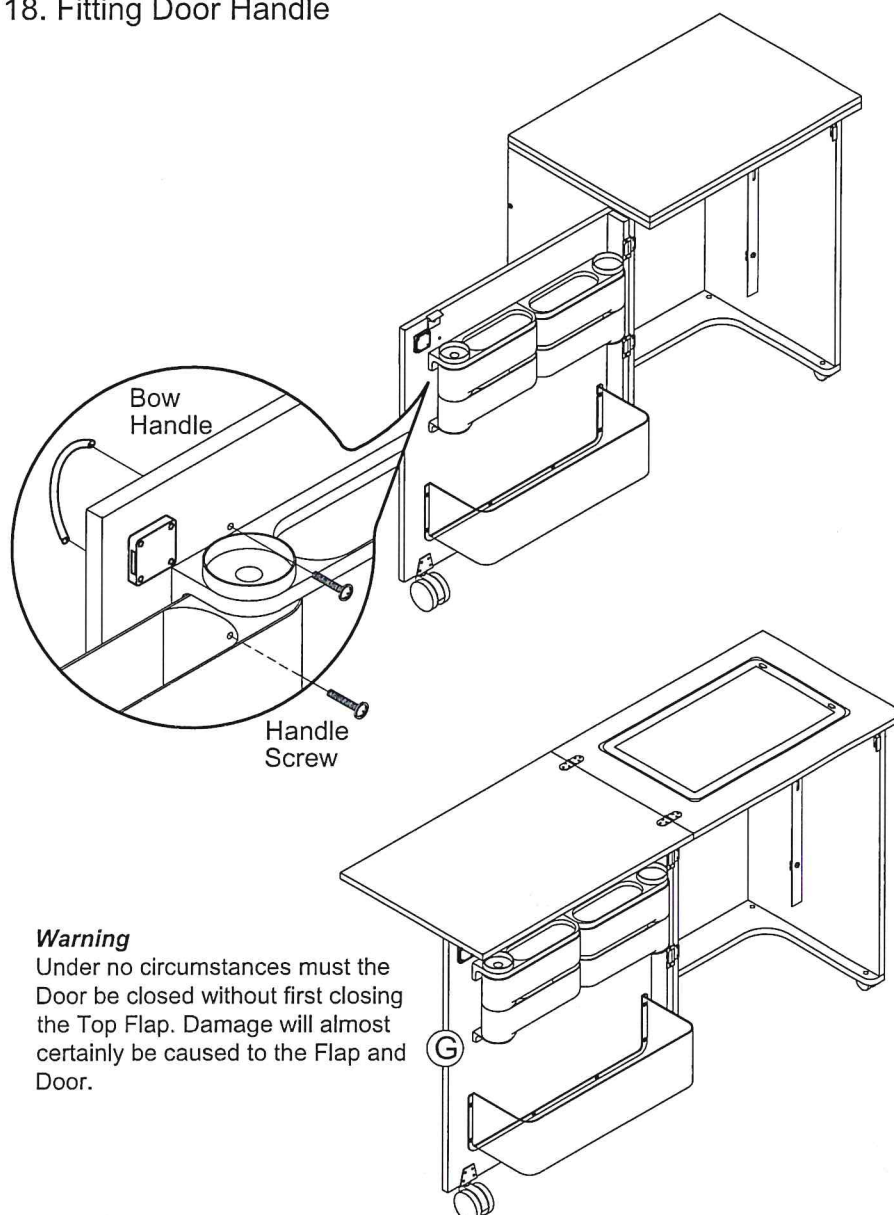

Warning

Under no circumstances must the Door be closed without first closing the Top Flap. Damage will almost certainly be caused to the Flap and Door.

Assembly Steps

1. Fit the Bow Handle using Handle Screws